

CAT. No.  
**111-10200**

HEATER INLET CONNECTOR, FLUSH MOUNT, SCREW TERMINALS, 155°C, 10 AMPERE 250 VOLT, 2 POLE 3 WIRE  
STANDARD: DIN 49458 (VDE 035)

APPROVALS / CERT'S.

CSA

SEV

VDE

ALL DIMENSIONS ARE IN MILLIMETERS

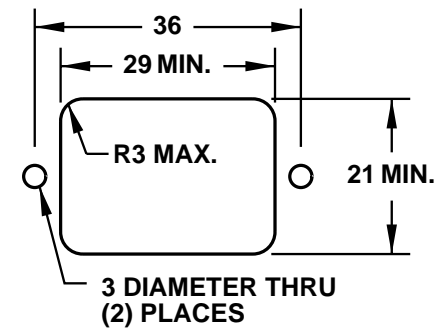
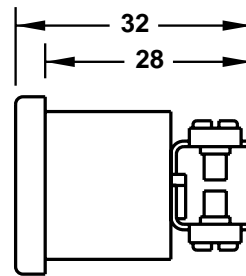
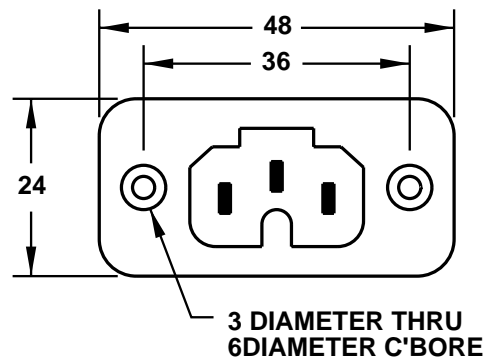

**MOUNTING HOLE**