

CAT. No.
111-10205

HEATER INLET CONNECTOR, SURFACE MOUNT, SCREW TERMINALS, 155°C, 10 AMPERE 250 VOLT, 2 POLE 3WIRE

STANDARD: DIN 49458 (VDE 035)

APPROVALS / CERT'S. | CSA | OVE | SEMKO | SEV | VDE

ALL DIMENSIONS ARE IN MILLIMETERS

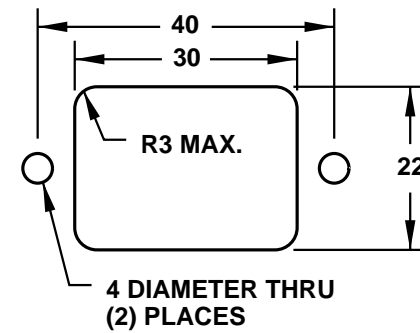
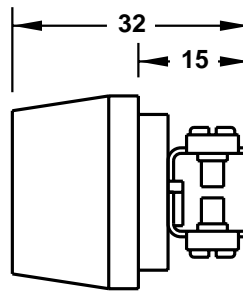
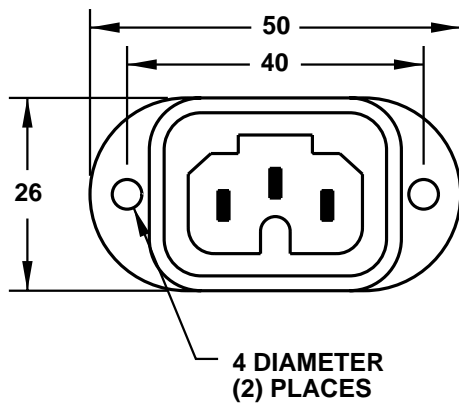

MOUNTING HOLE