

CAT. No.  
**57013**

IEC320 / CEE22 POWER INLET, SCREW MOUNT TO PANELS, BLACK, 2 POLE 3 WIRE, 4.8mm (1.87) TABS

STANDARD: IEC320

10A 250V

APPROVALS / CERT'S.

DEMKO

FI

IMQ

KEMA

NEMKO

OVE

SEMKO

SEV

VDE

15A 250V

APPROVALS / CERT'S.

CSA

UL

ALL DIMENSIONS ARE IN MILLIMETERS

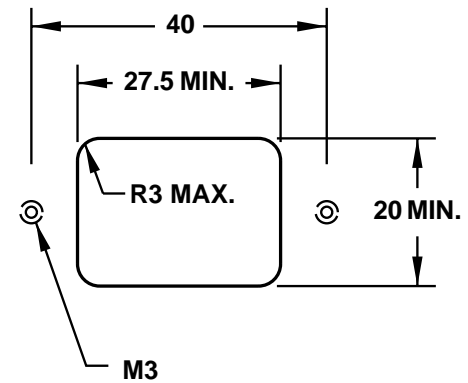
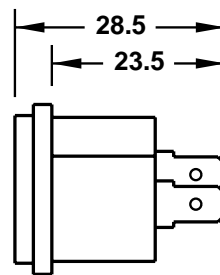
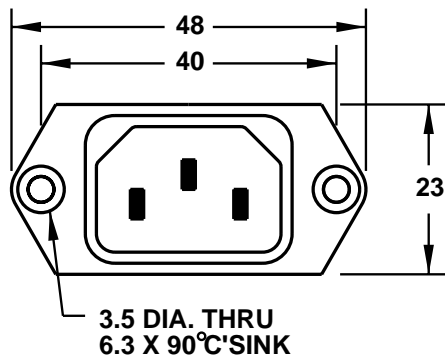

**MOUNTING HOLE**