

CAT. No.  
**57125**

IEC320 / CEE22 POWER OUTLET, SCREW MOUNT TO PANELS, BLACK, 2 POLE 3 WIRE, 4.8 mm (3/16") QC TABS.

STANDARD: IEC320

10A 250V

APPROVALS / CERT'S.

FI  IMQ  KEMA  NEMKO  OVE  SEMKO  SEV  VDE

15A 250V

APPROVALS / CERT'S.

CSA  UL

ALL DIMENSIONS ARE IN MILLIMETERS

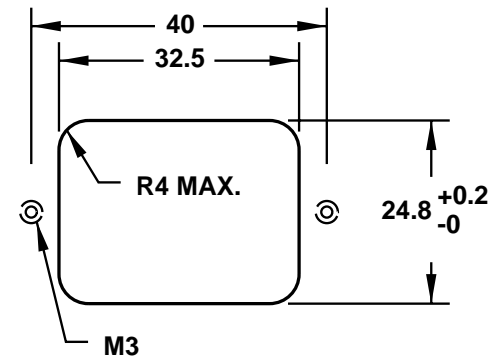
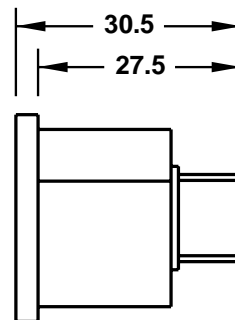
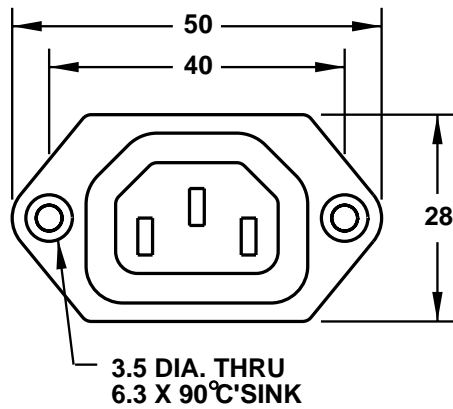

MOUNTING HOLE