

CAT. No.

**888-560306**

IEC 309 CEE 17 PANEL MOUNT SPLASHPROOF RECEPTACLE, ANGLE TYPE, BLUE, 60 AMPERE  
250 VOLT (UL/CSA); 63 AMPERE, 220-240 VOLT (EUROPEAN), 50/60HZ , 2 POLE + EARTH  
STANDARDS: IEC 309-1, IEC 304-2, BS 4343, DIN 49462/63, VDE 0623, CEE 17, EN 60309

APPROVALS / CERT'S.

CSA

SEV

UL

**ALL DIMENSIONS ARE IN MILLIMETERS**

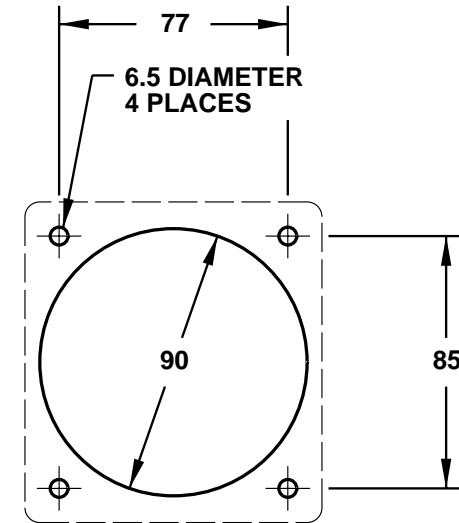
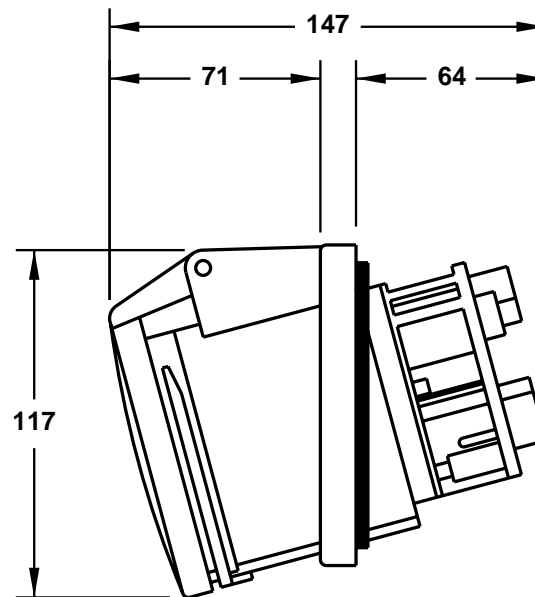
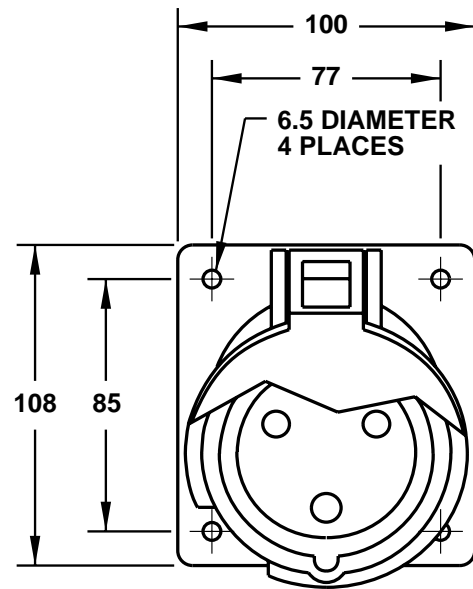

NOTE: FOR CLARITY THIS VIEW IS SHOWN WITH LIFT LID REMOVED

**PANEL CUTOUT**